

1100

MILLECENTO

by pininfarina



LINES 01 & 10 2 BEDROOMS / 2 BATHROOMS

TOTAL SQ.FT. 1,432 / TOTAL M² 133

AC Area 1,245 sq ft

Terrace Area 187 sq ft

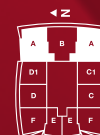

1100

MILLECENTO

by *pininfarina*

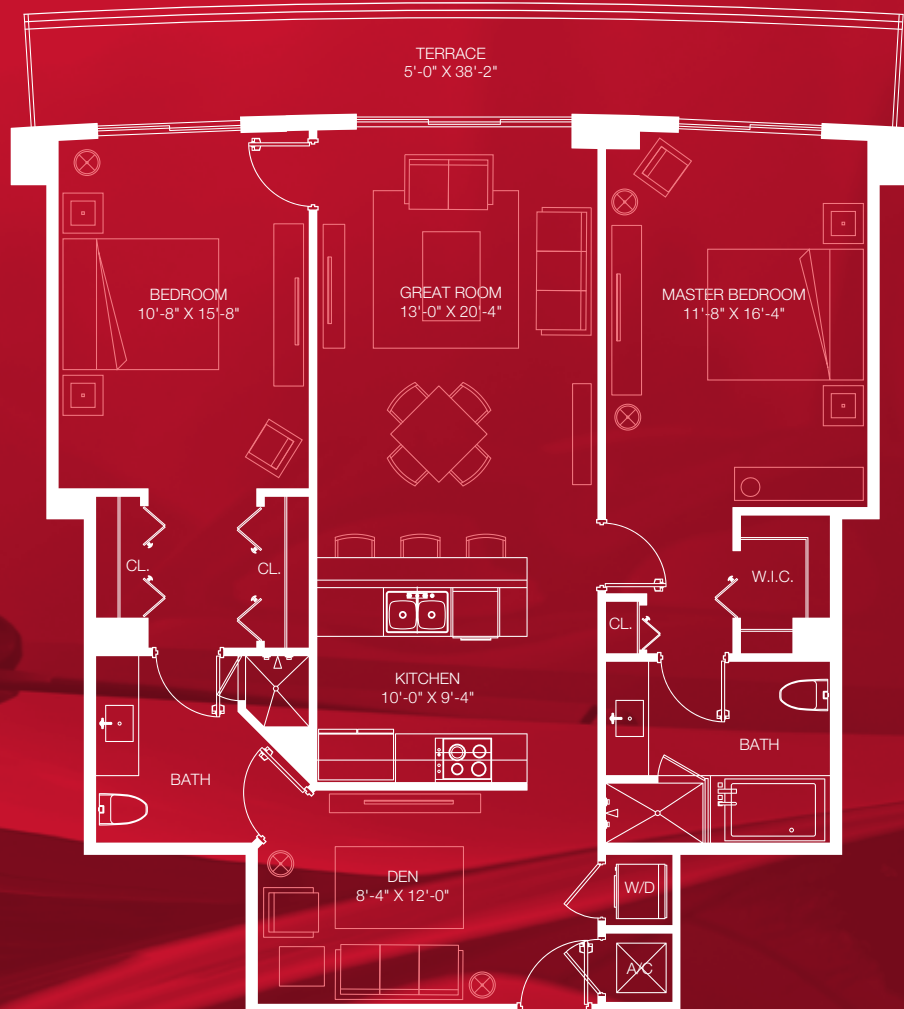

B

LINE 11 2 BEDROOMS / 2 BATHROOMS + DEN

TOTAL SQ.FT. 1,462 / TOTAL M² 136

AC Area 1,270 sq ft

Terrace Area 192 sq ft

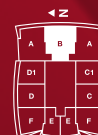

Stated dimensions are measured to the exterior boundaries of the exterior walls and the centerline of interior demising walls and in fact vary from the dimensions that would be determined by using the description and definition of the "Unit" set forth in the Declaration (which generally only includes the interior airspace between the perimeter walls and excludes interior structural components). For your reference, the area of the Unit, determined in accordance with those defined unit boundaries, is + or - 1,208 sq. ft. Note that measurements of rooms set forth on this floor plan are generally taken at the greatest points of each given room (as if the room were a perfect rectangle), without regard for any cutouts. Accordingly, the area of the actual room will typically be smaller than the product obtained by multiplying the stated length times width. All dimensions are approximate and may vary with actual construction, and all floor plans and development plans are subject to change.

1100

MILLECENTO

by pininfarina

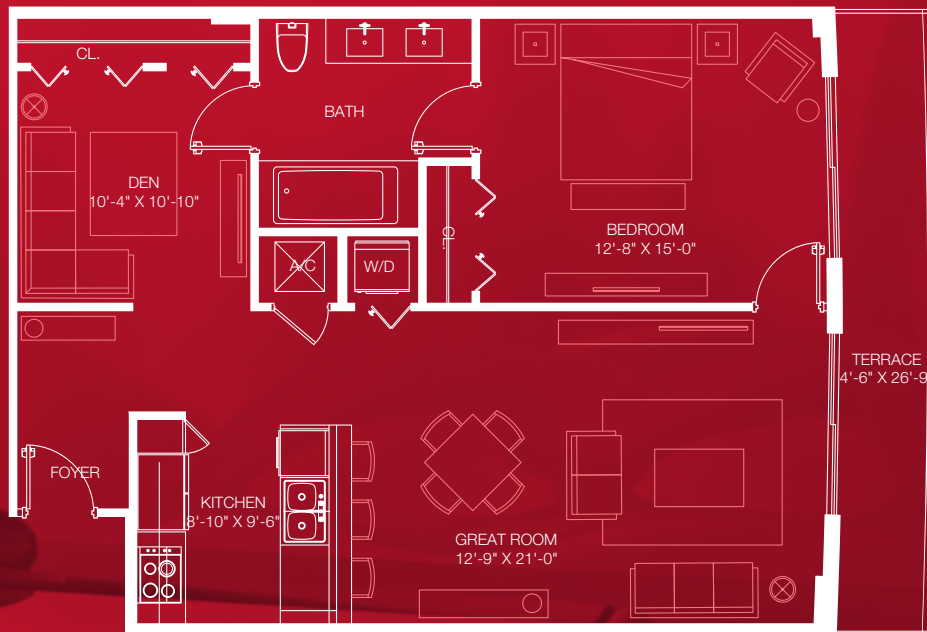

C

LINE 03 1 BEDROOM / 1 BATHROOM + DEN

TOTAL SQ.FT. 1,094 / TOTAL M² 102

AC Area 977 sq ft

Terrace Area 117 sq ft

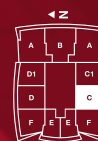

C1

LINE 02 1 BEDROOM / 1 BATHROOM + DEN

TOTAL SQ.FT. 1,062 / TOTAL M² 99

AC Area 942 sq ft

Terrace Area 120 sq ft

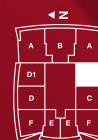

1100

MILLECENTO

by pininfarina

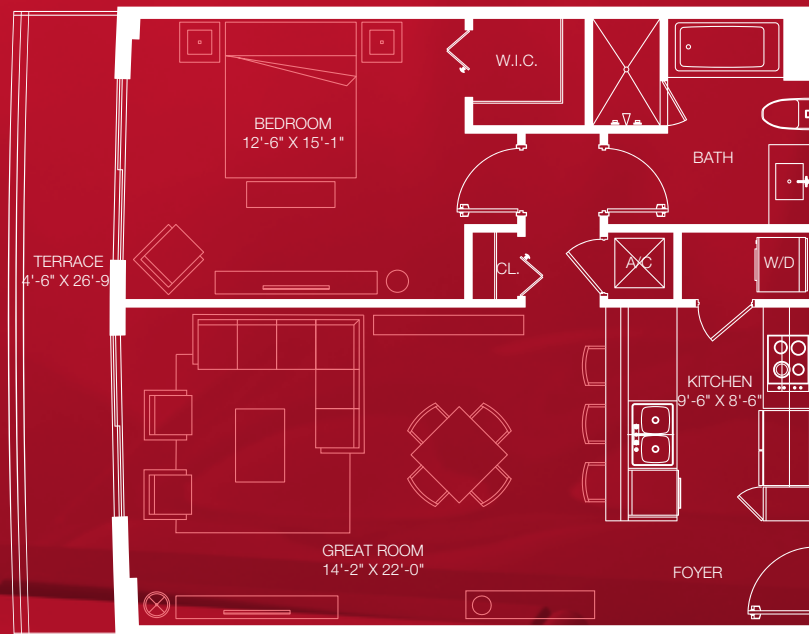

D

LINE 08 1 BEDROOM / 1 BATHROOM

TOTAL SQ.FT. 975 / TOTAL M² 91

AC Area 858 sq ft

Terrace Area 117 sq ft

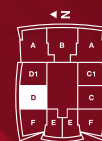

D1

LINE 09 1 BEDROOM / 1 BATHROOM

TOTAL SQ.FT. 936 / TOTAL M² 87

AC Area 816 sq ft

Terrace Area 120 sq ft



1100

MILLECENTO

by pininfarina

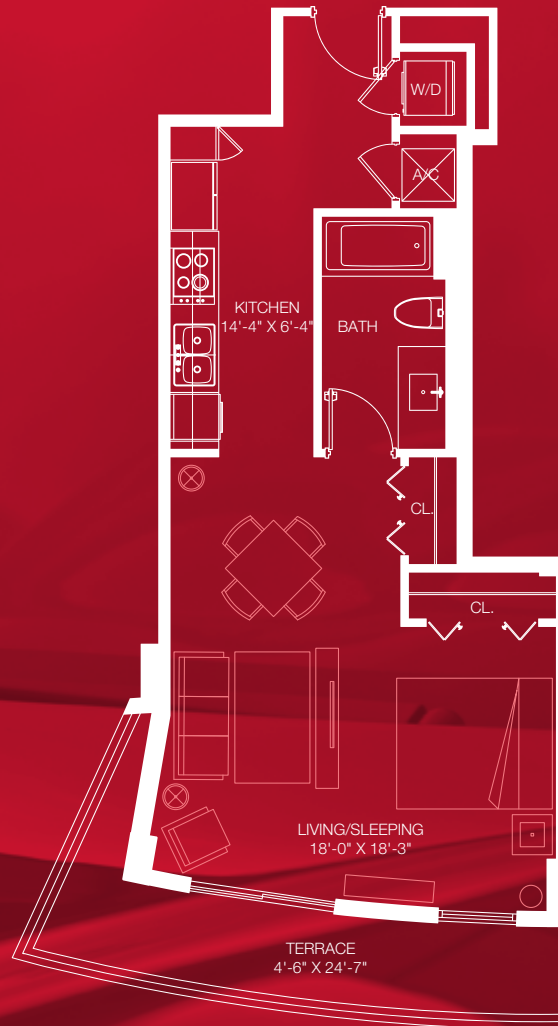

E

LINES 05 & 06 STUDIO / 1 BEDROOM CONVERTIBLE

TOTAL SQ.FT. 700 / TOTAL M² 65

AC Area 578 sq ft

Terrace Area 122 sq ft



1100

MILLECENTO

by pininfarina

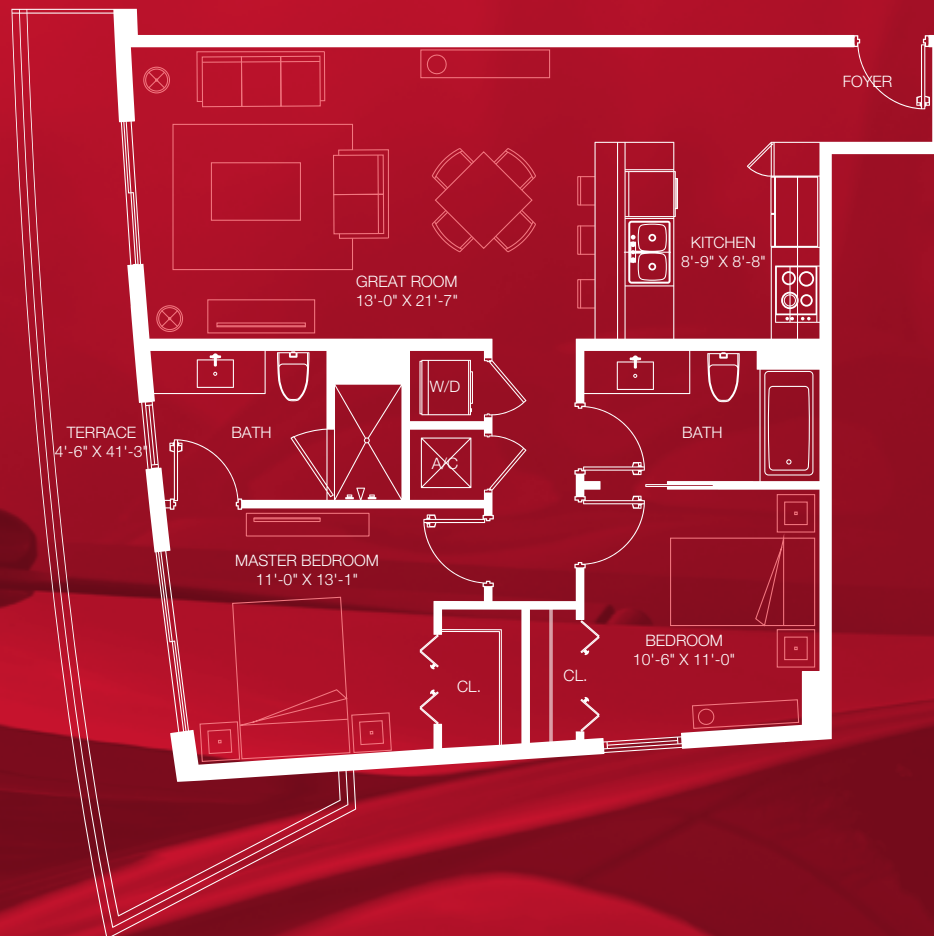

F

LINES 04 & 07 2 BEDROOMS / 2 BATHROOMS

TOTAL SQ.FT. 1,202 / TOTAL M² 112

AC Area 996 sq ft

Terrace Area 206 sq ft



Stated dimensions are measured to the exterior boundaries of the exterior walls and the centerline of interior demising walls and in fact vary from the dimensions that would be determined by using the description and definition of the "Unit" set forth in the Declaration (which generally only includes the interior airspace between the perimeter walls and excludes interior structural components). For your reference, the area of the Unit, determined in accordance with those defined unit boundaries, is + or - 936 sq ft. Note that measurements of rooms set forth on this floor plan are generally taken at the greatest points of each given room (as if the room were a perfect rectangle), without regard for any cutouts. Accordingly, the area of the actual room will typically be smaller than the product obtained by multiplying the stated length times width. All dimensions are approximate and may vary with actual construction, and all floor plans and development plans are subject to change.

SITE PLAN

TYPICAL FLOOR – Levels 10th to 42nd

1100

MILLECENTO

by pininfarina



11th STREET

